

For Lifting or Pulling Applications

G Series Ratchet Lever Hoists



3/4 - 15 Ton
Made in USA

COFFING G Series Model - Malleable iron roller chain ratchet lever hoists are efficient and durable. Roller chain can be spliced to create longer lifts and can handle higher capacities than coil chain. G Series hoists are ideal for utility transmission and distribution work.

- **CAPACITIES & LIFT** - Rated loads from 3/4 to 15 Tons. For standard lift, see chart below. Other lifts available.
- **RUGGED** - Unit and handle made from malleable iron. Riveted construction makes the unit tamper-resistant.
- **FREE CHAINING** - Free chaining mechanism allows quick and easy take-up and positioning of slack chain. Hoist will not free chain when under load.
- **HANDLE STOPS** - Prevent handle from spinning if it is accidentally released by the operator.
- **SINGLE OR DOUBLE LOCKING PAWL DESIGN** - See page 37.
- **MULTIPLE RIGGING OPTIONS** - Hoist can lift, pull, or bind. Can be operated from either side and will work in any position with equal efficiency.
- **SNAP HOOK AND LINK** - Allows operator to convert unit to next smaller capacity to give longer lift and faster operation. Snap hook acts as an end stop and will not pass through chain sprocket.
- **OPTIONS** - Bullard hooks, bronze hooks, and zinc-plated hooks - consult factory.
- **LIFETIME WARRANTY**

SPECIFICATIONS

G Series Ratchet Lever Hoists

Capacity		Model Number †	Standard Lift (In.)	Strands of Load Chain	Minimum Dist. Between Hooks (In.)	Handle Length (In.)	Minimum Increment (In.) †	Average Handle Effort (lbs.)	Net Weight (Lbs.)
Lbs.	Tons								
1500	3/4	AG/AGI	56 1/2	1	13	18 3/4	.624/.313	56	14
3000	1 1/2	ATG/ATGI	57	2	15	18 3/4	.313/.156	60	17
3000	1 1/2	FG/FGI	56 1/2	1	16	27 5/8	1.000/.500	116	25
6000	3	FTG/FTGI	57	2	17 5/8	27 5/8	.500/.250	120	34
9000	4 1/2	ZG-4 1/2	53	3	25	33 5/8	.333	124	49
12000	6	ZG-6	53	4	25	33 5/8	.250	124	59
18000	9	WG-9	60	5	30	33 5/8	.200	124	120
22000	11	WG-11	60	6	30	33 5/8	.167	124	130
26000	13	WG-13	60	7	30	33 5/8	.143	124	140
30000	15	WG-15	60	8	30	33 5/8	.125	124	150

† First designation is single pawl model and second "I" designation is double pawl model.

NOTE: For complete dimensional data, refer to Coffing Dimensional Databook.

G Series 3/4 - 15 Ton

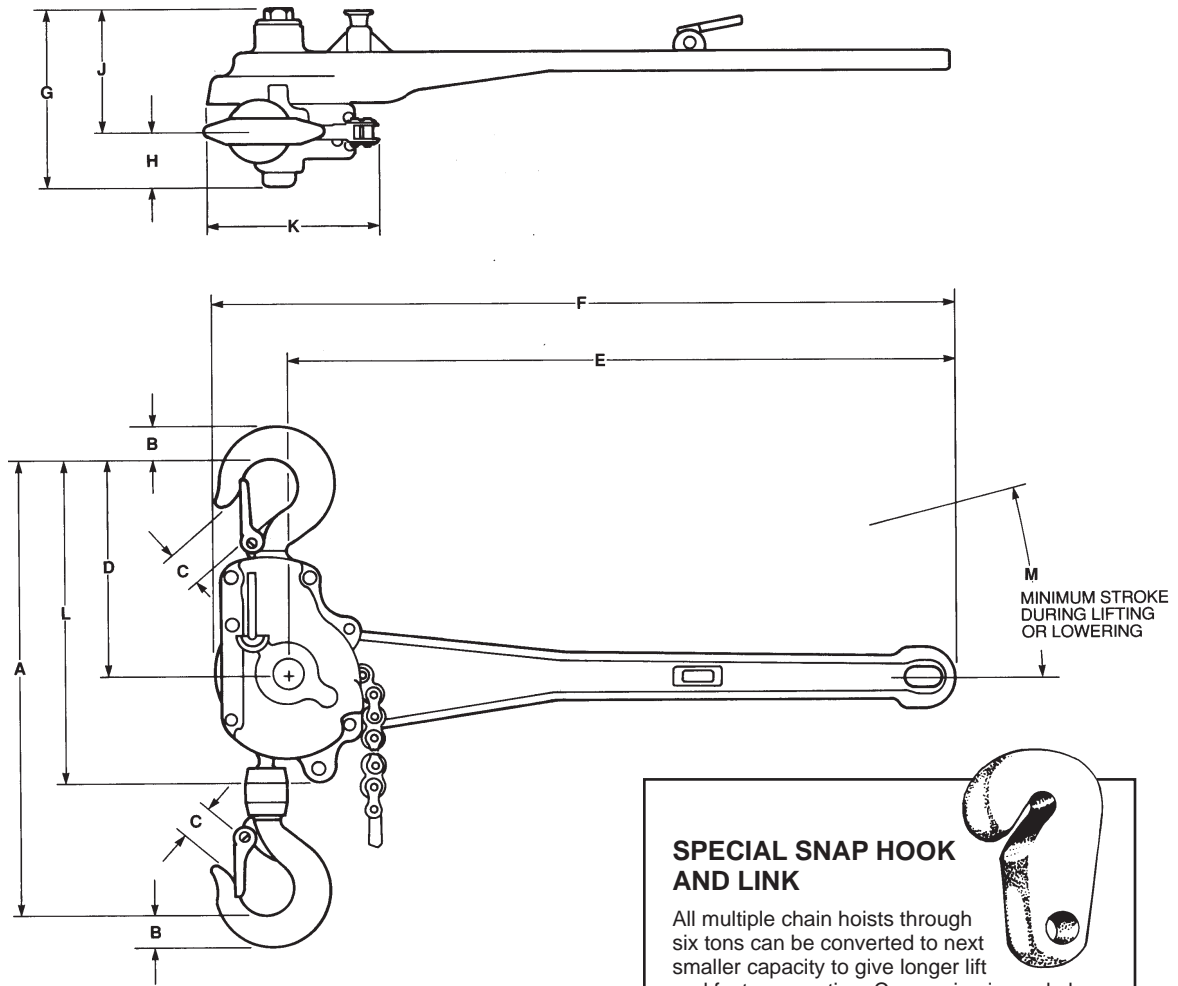

Dimensions

Model Number	A	B	C*	D	E	F	G	H	J	K	L	M
AG	13	1	1	6 ¹ / ₄	18 ³ / ₄	20 ³ / ₄	5	1 ¹ / ₂	3 ¹ / ₂	4 ¹ / ₂	9 ¹ / ₄	60°
AGI ¹	13	1	1	6 ¹ / ₄	18 ³ / ₄	20 ³ / ₄	5	1 ¹ / ₂	3 ¹ / ₂	4 ¹ / ₂	9 ¹ / ₄	30°
ATG ²	15	1	1	6 ¹ / ₄	18 ³ / ₄	20 ³ / ₄	5	1 ¹ / ₂	3 ¹ / ₂	4 ¹ / ₂	9 ¹ / ₄	60°
ATGI ^{1, 2}	15	1	1	6 ¹ / ₄	18 ³ / ₄	20 ³ / ₄	5	1 ¹ / ₂	3 ¹ / ₂	4 ¹ / ₂	9 ¹ / ₄	30°
FG	16	1 ¹ / ₈	1 ¹ / ₈	7	27 ⁵ / ₈	29 ⁷ / ₈	6 ¹ / ₄	1 ³ / ₄	4 ¹ / ₂	5 ³ / ₄	10 ¹ / ₄	60°
FGI ¹	16	1 ¹ / ₈	1 ¹ / ₈	7	27 ⁵ / ₈	29 ⁷ / ₈	6 ¹ / ₄	1 ³ / ₄	4 ¹ / ₂	5 ³ / ₄	10 ¹ / ₄	30°
FTG ³	17 ⁵ / ₈	1 ¹ / ₈	1 ¹ / ₈	7 ³ / ₈	27 ⁵ / ₈	29 ⁷ / ₈	6 ¹ / ₄	1 ³ / ₄	4 ¹ / ₂	5 ³ / ₄	10 ⁵ / ₈	60°
FTGI ^{1, 3}	17 ⁵ / ₈	1 ¹ / ₈	1 ¹ / ₈	7 ³ / ₈	27 ⁵ / ₈	29 ⁷ / ₈	6 ¹ / ₄	1 ³ / ₄	4 ¹ / ₂	5 ³ / ₄	10 ⁵ / ₈	30°
ZG-4 ¹ / ₂ ⁴ , ZG-6 ⁵	25	1 ¹³ / ₁₆	1 ¹¹ / ₁₆	8 ¹ / ₄	33 ⁵ / ₈	36 ¹ / ₈	6 ¹ / ₈	1 ¹¹ / ₁₆	4 ⁷ / ₁₆	6 ¹ / ₈	12 ⁷ / ₈	60°
WG-9, WG-13 WG-11, WG-15	30	2 ¹ / ₈	1 ⁵ / ₈	9 ¹ / ₈	33 ⁵ / ₈	41 ³ / ₈	6 ³ / ₈	1 ³ / ₄	4 ⁵ / ₈	13 ¹ / ₂	14 ⁵ / ₈	60°

¹Double Pawls — can be operated with half strokes of lever for use in close quarters.

²Convertible model — 1 chain 3/4 ton, 112" lift. 2 chains 1 1/2 tons, 57" lift.

³Convertible model — 1 chain 1 1/2 tons, 112" lift. 2 chains 3 tons, 57" lift.

⁴Convertible model — 2 chain 3 tons, 76" lift. 3 chains 4 1/2 tons, 51" lift.

⁵Convertible model — 3 chain 4 1/2 tons, 70" lift. 4 chains 6 tons, 53" lift.

All dimensions are in inches unless otherwise indicated.

**Minimum stroke on double locking pawl models (AGI, ATGI, FGI, FTGI) one-half (30°) that of single locking pawl models (AG, ATG, FG, FTG). Where clearance dimensions are critical, request certified print.